

# POLAND INTERNATIONAL EDUCATION FAIR

**Perspektywy 2025**

WARSAW, 25-26 September  
and regional fairs, fall 2025

Perspektywy 2025

- DECLARATION OF PARTICIPATION
- ADDITIONAL EQUIPMENT
- ACCOMPANYING EVENTS

[www.perspectives.pl](http://www.perspectives.pl)



# POLAND INTERNATIONAL EDUCATION FAIR

## Perspektywy 2025

WARSAW, 25-26 September  
and regional fairs, fall 2025

Exhibitor's stamp

### DECLARATION OF PARTICIPATION

**Name of Exhibitor:** (for invoicing purposes) \_\_\_\_\_  
**Full Address:** \_\_\_\_\_ **TAX ID no:** (obligatory) \_\_\_\_\_  
**Phone:** \_\_\_\_\_ **Fax:** \_\_\_\_\_ **Website:** \_\_\_\_\_  
**Contact:** (name) \_\_\_\_\_ **Phone:** \_\_\_\_\_  
**E-mail:** \_\_\_\_\_ **Mobile Phone:** \_\_\_\_\_

● **Exhibitor's signboard** (exhibitor's name and country, please use block or typed letters).

### Booth order – specification and rates (euro)

| City   | 4 m <sup>2</sup><br>(2m x 2m) | 6 m <sup>2</sup><br>(2m x 3m) | 8 m <sup>2</sup><br>(4m x 4m) | 12 m <sup>2</sup><br>(3m x 4m) | 16 m <sup>2</sup><br>(4m x 4m) |                          |
|--|-------------------------------|-------------------------------|-------------------------------|--------------------------------|--------------------------------|--------------------------|
| ● <b>Gdańsk, 4-5.09</b> , University of Gdansk                             | 1250                          | 1640                          | 1950                          | 2490                           | 3490                           | <input type="checkbox"/> |
| ● <b>Szczecin, 8-9.09</b> , University of Szczecin                         | 1150                          | 1500                          | 1800                          | 2200                           | 2980                           | <input type="checkbox"/> |
| ● <b>Opole, 10.09</b> , University of Opole                                | 960                           | 1200                          | 1350                          | 1630                           | 2050                           | <input type="checkbox"/> |
| ● <b>Łódź, 11-12.09</b> , Łódź University of Technology                    | 1250                          | 1640                          | 1950                          | 2490                           | 3490                           | <input type="checkbox"/> |
| ● <b>Wrocław, 15-16.09</b> , Wrocław University of Science and Technology  | 1250                          | 1640                          | 1950                          | 2490                           | 3490                           | <input type="checkbox"/> |
| ● <b>Toruń, 15-16.09</b> , Nicolaus Copernicus University in Toruń         | 1150                          | 1500                          | 1800                          | 2200                           | 2980                           | <input type="checkbox"/> |
| ● <b>Poznań, 17-18.09</b> , Poznań University of Technology                | 1250                          | 1640                          | 1950                          | 2490                           | 3490                           | <input type="checkbox"/> |
| ● <b>Kielce, 19.09</b> , Kielce University of Technology                   | 960                           | 1200                          | 1350                          | 1630                           | 2050                           | <input type="checkbox"/> |
| ● <b>Olsztyn, 19.09</b> , University of Warmia and Mazury in Olsztyn       | 960                           | 1200                          | 1350                          | 1630                           | 2050                           | <input type="checkbox"/> |
| ● <b>Kraków, 22-23.09</b> , Jagiellonian University of Kraków              | 1250                          | 1640                          | 1950                          | 2490                           | 3490                           | <input type="checkbox"/> |
| ● <b>Białystok, 23.09</b> , University of Białystok                        | 960                           | 1200                          | 1350                          | 1630                           | 2050                           | <input type="checkbox"/> |
| ● <b>Warszawa, 25-26</b> , SGH Warsaw School of Economics                  | 1420*                         | 1890                          | 2200                          | 3390                           | 3890                           | <input type="checkbox"/> |
| ● <b>Warszawa, 25-26</b> , SGH Warsaw School of Economics PREMIUM          | 1720*                         | 2340                          | 2750                          | 4240                           | 4860                           | <input type="checkbox"/> |
| ● <b>Rzeszów, 25-26</b> , University of Rzeszow                            | 1150                          | 1500                          | 1800                          | 2200                           | 2980                           | <input type="checkbox"/> |
| ● <b>Katowice, 29-30.09</b> , University of Silesia in Katowice            | 1150                          | 1500                          | 1800                          | 2200                           | 2980                           | <input type="checkbox"/> |
| ● <b>Lublin, 29-30.09</b> , The John Paul II Catholic University of Lublin | 1150                          | 1500                          | 1800                          | 2200                           | 2980                           | <input type="checkbox"/> |

\* Instead of 4 meters only 4,5 meters are possible in Warsaw

### E-catalogue profile – 50 words/85 Euro (obligatory)

☒ **85 EURO**

Profile will be published in the Exhibitor's e-Catalogue at the [salonmaturzystow.pl](http://salonmaturzystow.pl), which will include: exhibitor name, address, phone, social media, fax, website and brief description. Description exceeding 50 words will be subject to extra charge, 70 Euro/each additional 50 words started. The organizer shall not be held liable for content or errors in the catalogue, resulting from illegibly filled forms.

**Profile should be send by e-mail to: [fair@perspektywy.pl](mailto:fair@perspektywy.pl)**

**Total** .....

### Conditions

When accepted and signed by the exhibitor, this application becomes a contract and is binding for both parties, on the date written below, in accordance with Poland International Education Fair Terms and Conditions. Booth location is determined by the organizer. (according to the floorplan at [www.perspectives.pl/floorplan](http://www.perspectives.pl/floorplan)).

Bank PEKAO SA, Aleje Jerozolimskie 65/79, 00-693 Warsaw, Poland; IBAN: PL68 1240 6218 1111 0000 4622 3881; BIC/SWIFT: PKOPPLPW

**Entry deadline: 30 August, 2025 – late registration**

**Participation in two cities – 5% discount, three and four – 10% discount, five and eight – 15% discount, ten on more – 20% discount.**

**Early bird: 30 June 25% discount**

**IMPORTANT NOTICE: All prices are subject to VAT.**

**All payments shall be made by the date set on the pro-forma invoice.**

Please complete this form using block or typed letters and return signed to: Perspektywy Press,  
Nowogrodzka 31, 00-511 Warsaw, Poland. Tel: +48 22 628 58 62; +48 22 621 75 26; Fax +48 22 629 16 17  
Contact: [reklama@perspektywy.pl](mailto:reklama@perspektywy.pl)

More information [www.salonmaturzystow.pl](http://www.salonmaturzystow.pl)

.....  
Date, signature, company seal

## STANDS SCHEME WITH STANDARD EQUIPMENT

### 4 sq meters stand

(2m wide x 2m deep)  
accept Warsaw

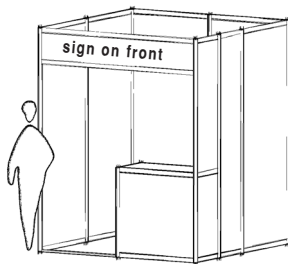
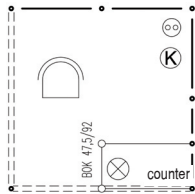

#### Equipment (included):

- counter • 1 chair • sign on front
- 1 light point • 1 electric socket • waste basket

### 4,5 sq meters stand

(3m wide x 1,5m deep)  
only in Warsaw

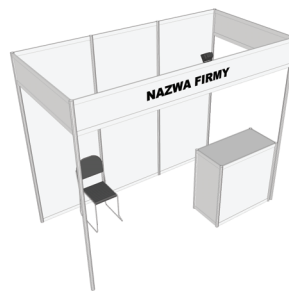
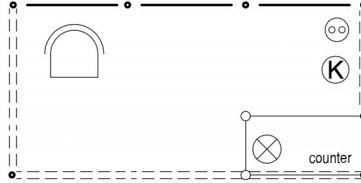

#### Equipment (included):

- counter • 1 chair • sign on front
- 1 light point • 1 electric socket • waste basket

### 6 sq meters stand

(3m wide x 2m deep)

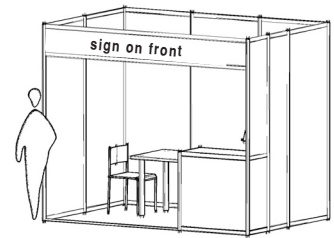
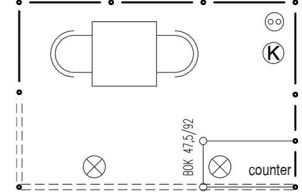

#### Equipment (included):

- counter • 2 chairs • sign on front • 1 table
- 2 light points • 1 electric socket • waste basket

### 8 sq meters stand

(4m wide x 2m deep)

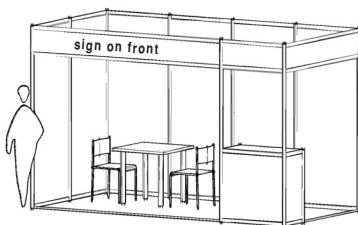
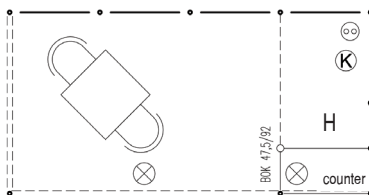

#### Equipment (included):

- counter • 2 chairs • sign on front • 1 table
- 1 barstool • 2 light points • 1 electric socket
- waste basket

### 12 sq meters stand

(4m wide x 3 m deep)

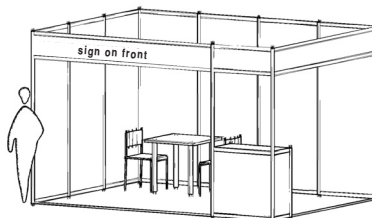
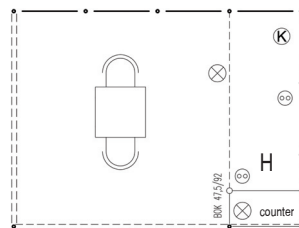

#### Equipment (included):

- counter • 2 chairs • sign on front • 1 table
- 3 light points • 2 electric sockets • waste basket
- 1 stool bar

### 16 sq meters stand

(4m wide x 4 m deep)

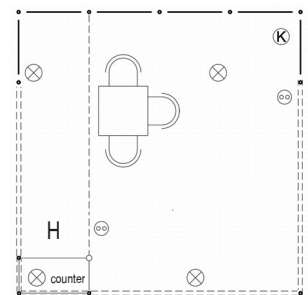

#### Equipment (included):

- counter • 3 chairs • sign on front • 1 table
- 3 light points • 2 electric sockets • waste basket
- 1 stool bar

### Notice

Additional equipment can be ordered from another document-price list. We would like to inform all the exhibitors that the stands are located in the main halls of the Universities. The Organizer reserves the right to determine the stands' location, with the exception of the Premium location in Warsaw. Exhibitors are not allowed to put stickers on the walls or damage the stand back walls, fixing decorations with nails, screws etc. The Organizer shall not be responsible for the transport of materials.

Exhibitor's stamp



ADDITIONAL EQUIPMENT – PRICE LIST

Entry deadline: 30 August 2025 – late registration

City: ..... (should equipment differ in each city, please fill in a separate form)

| No. | Equipment and furnishing   | Measure unit    | Price EURO | Number ordered | Total |
|-----|--|-----------------|------------|----------------|-------|
| 1   | Vacant exhibition area (min. 4m²)  | 1 m²            | 220        |                |       |
| 2   | Storage area (panel walls + door)  | 1 item          | 90         |                |       |
|     | (panel walls + curtain)  | 1 item          | 75         |                |       |
| 3   | Carpet   | 1 m²            | 35         |                |       |
| 4   | Table  | 1 item          | 40         |                |       |
| 5   | Bar table  | 1 item          | 55         |                |       |
| 6   | Bar stool  | 1 item          | 40         |                |       |
| 7   | Chair  | 1 item          | 25         |                |       |
| 8   | Bookshelf, straight/diagonal (100x25)  | 1 item          | 20         |                |       |
| 9   | Counter (100x100x50)   | 1 item          | 80         |                |       |
| 10  | Showcase, glazed (90x100x50)   | 1 item          | 70         |                |       |
| 11  | Bookstand (220x100x50)   | 1 item          | 65         |                |       |
| 12  | Bookstand with glazed shelves (220x100x50)                                     | 1 item          | 75         |                |       |
| 13  | Panel wall (100x250)   | 1 item          | 40         |                |       |
| 14  | Podium (50x100x700)  | 1 item          | 45         |                |       |
|     | (50x100x100)   | 1 item          | 50         |                |       |
|     | (100x100x70)   | 1 item          | 60         |                |       |
|     | (100x100x100)  | 1 item          | 70         |                |       |
| 15  | Electric socket  | 1 item          | 30         |                |       |
| 16  | Extra light (spotlight)  | 1 item          | 30         |                |       |
| 17  | Coat rack  | 1 item          | 25         |                |       |
| 18  | Waste-paper-basket   | 1 item          | 15         |                |       |
| 19  | Superiority of the stand (without the graphics)                                | 1m high         | 140        |                |       |
| 20  | Company signboard  | 1 item          | 60         |                |       |
| 21  | Logo on the signboard  | 1 item          | 75         |                |       |
| 22  | Logo in the Exhibitors' e-catalogue  | 1 item          | 50         |                |       |
| 23  | Entry in Exhibitors' e-Catalogue (up to 50 words) obligatory (1 for each city) |                 | 80         |                |       |
| 24  | Sub-Exhibitor's entry in the e-Catalogue (up to 50 words) obligatory           |                 | 70         |                |       |
| 26  | Fixing TV to the wall panel / mobile LCD stand                                 | 1 item          | 90/80      |                |       |
| 27  | TV min. 42"/50"  | 1 day           | 160/200    |                |       |
| 28  | Multimedia projector   | 1 day           | 80         |                |       |
| 29  | Projection screen  | 1 day           | 70         |                |       |
| 30  | Laptop   | 1 day           | 60         |                |       |
| 31  | Conference room 60-100 seats   | 30 min./ 1 hour | 190/320    |                |       |
| 32  | Hostess translator (to assist at your stand)                                   | 1 day           | 150        |                |       |
| 33  | Hostess – leaflets distribution (1 person)                                     | 1 day           | 135        |                |       |
| 34  | Roll'up– preparation (1 m x 2 m)   | 1 item          | 220        |                |       |
| 35  | Banner – exposition next to the entrance                                       | 1 days          | 250        |                |       |
| 36  | Graphics   | 1 sqm           | 95         |                |       |

IMPORTANT NOTICE:  
All prices are subject to VAT. All payments shall be made by the date set on the pro-forma invoice.

.....  
Date, signature, company seal



# POLAND INTERNATIONAL EDUCATION FAIR

**Perspektywy 2025**

**WARSAW, 25-26 September  
and regional fairs, fall 2025**

## ACCOMPANYING EVENTS' APPLICATION FORM

Entry deadline: **15 August, 2025**

Please complete this form (in English) using block or typed letters and deliver to the Organizer by e-mail to the following address:  
fair@perspektywy.pl

**Organizer** \_\_\_\_\_

**1. Type of the event** \_\_\_\_\_

**Title** \_\_\_\_\_

**Description of the event** (for the Accompanying Events Calendar) \_\_\_\_\_

**Date** \_\_\_\_\_

**Hour** \_\_\_\_\_ **Duration** (150 Euros – 30 min, 250 Euros – 60 min.) \_\_\_\_\_

**Conference room** with standard equipment (laptop, multimedia projector, projector screen, microphone) \_\_\_\_\_

**Additional requests** (additional equipment, etc.) \_\_\_\_\_

**Contact person** (position, name, tel., fax, e-mail) \_\_\_\_\_

**2. Type of the event** \_\_\_\_\_

**Description of the event** (for the Accompanying Events' Calendar) \_\_\_\_\_

**Date** \_\_\_\_\_

**Hour** \_\_\_\_\_ **Duration** \_\_\_\_\_

**Conference room** \_\_\_\_\_

**Other location** \_\_\_\_\_

**Additional requests** (equipment, etc.) \_\_\_\_\_

**Contact person** (position, name, tel., fax, e-mail) \_\_\_\_\_

The seminar program will be widely promoted through the media, university publications, magazines for higher education, newsletters and posters distributed at high schools, universities and other educational institutions.  
However, the organizer is not responsible for the number of listeners.

.....  
Date, signature, company seal

# TERMS AND CONDITIONS

## POLAND INTERNATIONAL EDUCATION FAIR **Perspektywy 2025**

### TERMS AND CONDITIONS

I. Written and signed Declaration of Participation at the Poland International Education Fair PERSPEKTYWY is equivalent to entering into an agreement by and between Organizer – PERSPEKTYWY PRESS and Exhibitor, under Terms and Conditions as defined in this document.

### II. GENERAL INFORMATION

#### NAME:

PERSPEKTYWY Poland International Education Fair  
FALL 2025

#### ORGANIZER:

PERSPEKTYWY PRESS  
31 Nowogrodzka St., 00-511 Warsaw, Poland  
Tel.: +48 22 628 58 62; 621 75 26;  
Fax: +48 22 629 16 17;  
E-mail: fair@perspektywy.pl  
Internet: www.perspectives.pl

#### EXHIBITORS:

Institutions, which present an offer adequate for the theme of the event and those accepted by the Organizer, are allowed to participate in the Fair.

#### PROGRAMME:

During the term of the Fair, accompanying events shall be organized, with a separate application form. Applications for such events should be delivered to the Organizer by no later than **30 August, 2025**.

#### FAIR IN WARSAW:

##### VENUE:

Warsaw School of Economics  
al. Niepodleglosci 162, 02-554 Warsaw, Poland

##### TIME SCHEDULE:

25-26 September, 2025

##### OPENING HOURS:

9:00 am to 3:00 pm

##### ASSEMBLY OF STANDS:

24 September 2024 – 5:00 pm to 7:00 pm

##### DISASSEMBLY OF STANDS:

26 September 2025 – 3:00 pm to 6:00 pm

REGIONAL FAIRS: see [www.perspectives.pl/regionalfairs](http://www.perspectives.pl/regionalfairs)

### III. RULES OF PARTICIPATION

1. The conditions for taking part in the Fair is to deliver on the Organizer's address, a legible filled (using block or typed letters) Declaration of Participation **by no later than 30 August, 2025**.

Applications submitted past this date shall be considered on a conditional basis, according to the sequence of receipt, and conditional upon the exhibiting area being available upon receipt of such application.

2. Participation in the Fair shall be confirmed by means of a pro-forma document or invoice.

3. Each Exhibitor and Sub-Exhibitor shall submit company information, in order to provide the **obligatory entry in the Exhibitors' e-Catalogue**. The Catalogue Entry is payable. The Organizer shall not be held responsible for the content of the entry made.

4. Concerning additional orders, the Exhibitor shall bear separate payments, according to the binding price list.

5. The Organizer may terminate the Agreement without indicating the reason for such termination. Exhibitors, who did not fulfil their commitments to the Organizer, may meet with a refusal to participate in the Fair.

### IV. STAND ARRANGEMENT, LOCATION

1. Exhibitor has the possibility to select and reserve the location of the stand. Perspektywy reserves the right to change booth assignment at any time as deemed necessary. The Exhibitor receives the pro forma invoice one week from the registration as the order confirmation. The original invoice will be sent by post.

2. The stand shall not be made available in whole or in part to a third party without Organizer's prior consent.

3. One week before beginning of the Fair, the Organizer shall inform the Exhibitor regarding assigned location and the stand number.

4. Assembly of the stand shall take place on **24 September, 2025 from 4:00 pm to 7:00 pm** applies to Warsaw. For other fairs see: [www.perspectives.pl/regionalfairs](http://www.perspectives.pl/regionalfairs)

a. Exhibits shall not be placed in passages adjacent to the stand.

b. The Exhibitor's equipment displays, artistic performances and other promotional activities shall be discussed with the Organizer prior to the event and shall not obstruct or prevent operation of other stands and the movement of public and performers.

c. Any sound- provision or audio- visual equipment held at the stand should be used in a manner not disturbing the operation of neighbouring stands.

5. Disassembly of stands shall take place on **26 September, 2025 from 3:00 pm to 6:00 pm** applies to Warsaw. For other fairs see: [www.perspectives.pl/regionalfairs](http://www.perspectives.pl/regionalfairs). The Organizer shall not bear responsibility for any belongings left on stands past the set date and time.

6. Stands shall not be cleared before the official opening date of the Fair.

7. The Exhibitor shall not introduce any modifications to the standard stand design and shall not introduce additional decorative features as graphic elements, panels, ornaments or decorations which exceed standard dimensions, without the Organizer's explicit consent.

8. The Exhibitor shall be allowed to display advertisements and promotional materials outside the assigned stand at additional fee.

9. The Exhibitor shall bear the sole financial responsibility for the stand equipment and furnishing delivered by the Organizer. The cost of any damage and losses resulting from inadequate stand use shall be borne by the Exhibitor.

10. Any electric works within the stand may be performed solely and exclusively by people authorised by the Organizer.

11. **The Exhibitor shall be eligible to put forward claims concerning issues related to the stand equipment, no later than the first hour of duration of the fair.**

12. The entire Fair area is non smoking zone, with the exception of especially designed marked places.

### V. TRANSPORTATION

1. The Exhibitor is obliged to transport the exhibits at his own cost. The Organizer shall not be responsible for the transportation, therefore he is not responsible for the possible losses irrespective of cause.

### VI. ORDER REGULATIONS

1. **Before the opening of the Fair, the Exhibitor is obliged to meet the Organizer at the Organizer's Office in order to register, receive badges and accept the stand.**

2. The Exhibitor is obliged to follow sanitary security and fire regulations as well as all internal rules.

3. The Exhibitor is obliged to maintain order within his stand. The Organizer provides cleaning service, but does not interfere with the area rented by the Exhibitor.

4. Exhibition materials should not block passages evacuation exits and fire equipment.

### VII. TERMS OF PAYMENT

1. The fees due for lease of the stand and services are quoted in the price-list of the PERSPEKTYWY Poland International Education Fair.

2. All payments in EURO shall be made by the Exhibitor no later than by the date set on the pro-forma document or invoice.

Any banking fees shall be borne by the Exhibitor.

The Exhibitor shall receive an invoice after making a full payment for the stand.

3. **Payments shall be made to the following account:**

PERSPEKTYWY PRESS

Nowogrodzka 31, 00-511 Warsaw, Poland

Bank name: Bank PEKAO SA

Oddział w Warszawie

Bank address: Aleje Jerozolimskie 64/79, 00-693 Warsaw, Poland

IBAN (International Bank Account Number):

PL 68 1240 6218 1111 0000 4622 3881

BIC/SWIFT: PKOPPLPW

Please indicate: Fall 2022 and Exhibitor name.

Please send a copy of the bank transfer to:

PERSPEKTYWY PRESS, fax: +48 22 629 16 17

4. The Organizer shall have the right to cancel the Exhibitor's entry request without the right of compensation if the fee for stand lease is not transferred to the Organizer's bank account by the date set on the pro-forma document or invoice.

### VIII. SECURITY AND INSURANCE

1. The Organizer shall be responsible for stand security outside fair opening hours. The Organizer does not bear any responsibility for the Exhibitors' and Visitors' property, accidents and damages to the property irrespective of the cause, except for damages effected through Organizer's fault, which is evident or stated by a binding adjudication.

2. The Organizer shall not be liable for losses resulting from theft, fire, hurricane, lightning strike, explosion, flooding, power failures and other causes which remain beyond Organizer's control.

3. The Organizer shall not be held liable for changes in the date of the Fair, cancellation or disruption of the Fair, changes in organizational and financial terms resulting from force majeure incidents or a decision of national authorities.

4. The Exhibitor is advised to provide itself with an additional insurance regarding from the participation in the Fair as well as the insurance of the exhibits displayed.

5. The Exhibitor shall secure valuable objects at his own discretion. The Exhibitor is advised to leave all valuable objects in accessible on the Fair area security deposit.

### IX. CANCELLATION OF PARTICIPATION

1. Cancellation of the Fair due to the unambiguous causes on the Organizer's part, results in the duty to reimburse the Exhibitor for the fees collected by the Organizer.

2. Cancellations of the Fair due to causes for which the Organizer is not responsible, does not constitute the basis for reimbursement of the fees collected from the Exhibitor.

3. The Exhibitor shall cancel participation in the PERSPEKTYWY Poland International Education Fair in writing (fax followed by the original notice) under pain of nullity. **The date of cancellation shall be the date on which the Organizer receives the note of cancellation.** Participation costs shall be refunded in full for notes of cancellation submitted by 20<sup>th</sup> August 2025. Exhibitors who submit notes of cancellation no later than by 31 August 2025 shall receive 50% of the value of the pro-forma invoices confirming Exhibitor's orders. Exhibitors who submit notes of cancellation past 31 August 2025 shall forfeit 100% of the value of the pro-forma invoices confirming Exhibitor's orders, as a contractual penalty under the agreement concluded by PERSPEKTYWY PRESS and the Exhibitor.

### X. FINAL PROVISIONS

1. Any claims must be delivered in writing. Any disputes, after exhausting a possibility of an amicable solution, should be referred to the court being competent for resolving any possible disputes as may appear in the context of implementation of the provisions of these „Terms and conditions of participation”. It shall be a civil court with respect to the Fair Organizer's seat.

*Perspektywy*